



1. APPLICATIONS

Control panel for 1 motor at 230 or 380 Vac single-phase or three-phase with neutral, it has power stage with safety contactors, it is available with magnetic motor circuit breaker, finished industrial or domestic housings. It is compatible with WIRELESSBAND system.

Supports:

- DMT: Magnetic selector card /safety int. / opening.
- SRT BAND: WIRELESSBAND system receiver card for resistive / optical safety edge.
- SRT: Radio card receiver for 433 or 868 Mhz radio transmitters.

2. SETTING UP INSTRUCTIONS

- The control unit can be activated by Test CI, P.ABRIR(26-28) or via the radio card. Manoeuvres can be finalised via the following: limit switch activation, end of working time or by encoder .
- Pressing the STOP (25-26) button stops the door. It is necessary to push OPEN or CLOSE buttons to reactivate the operation.

3. CONNECTIONS

LEDS:

- | | |
|-----------------------|----------------------|
| 1. Open | 5. Close safety |
| 2. Close | 6. Stop |
| 3. Limit Switch Open | 7. Close push button |
| 4. Limit Switch Close | 8. Open push button |

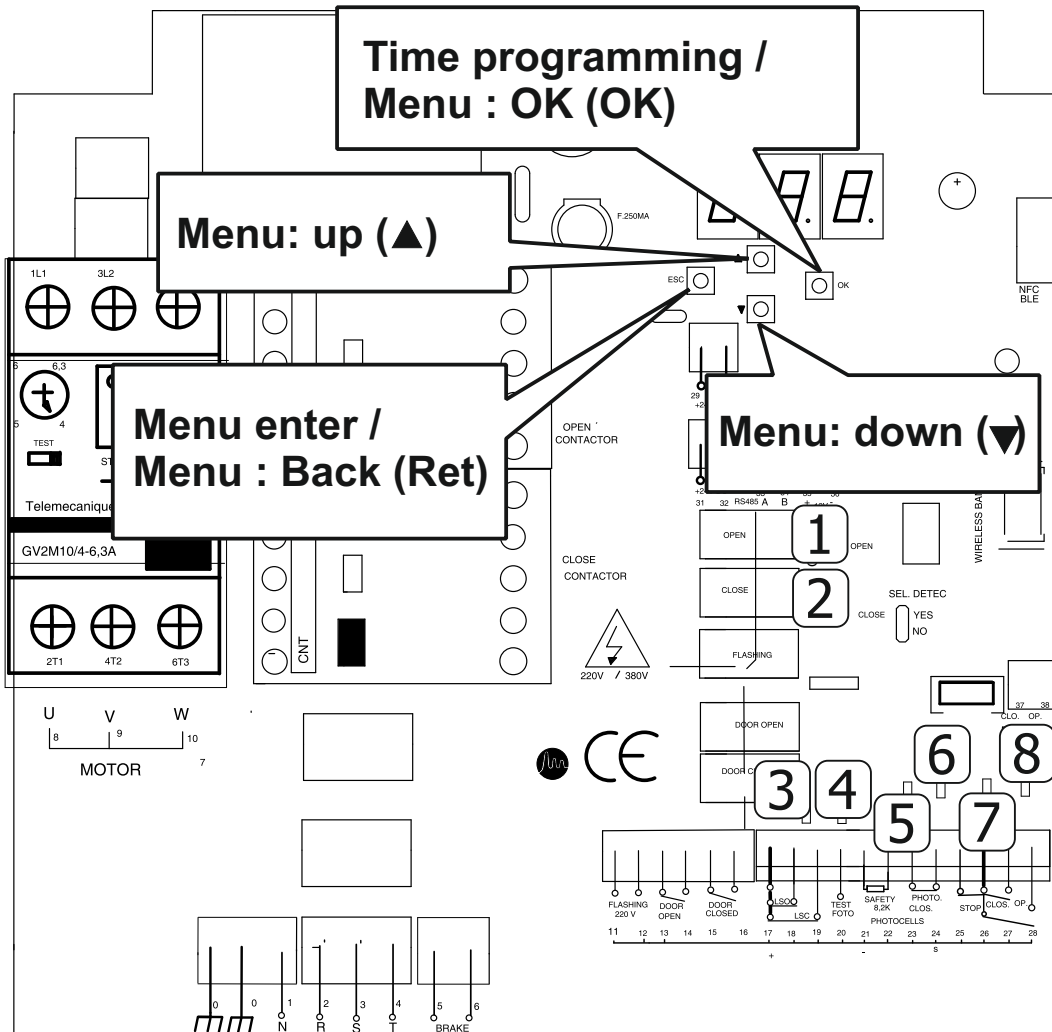

3.1 POWER SUPPLY & MOTOR CONNECTIONS

380V

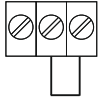

230V



TRIPHASE
POWER SUPPLY

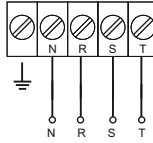

380V TRIPHASE
MOTOR

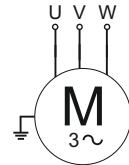

230V TRIPHASE
POWER SUPPLY
NO NEUTRAL

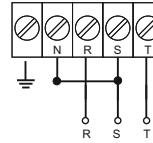

230V TRIPHASE
MOTOR

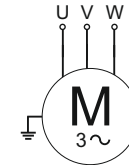

MONOPHASE
POWER SUPPLY

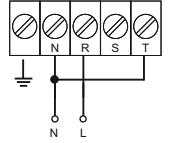

230V MONOPHASE
MOTOR

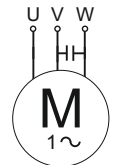

3.2 TERMINAL CONNECTIONS

BRAKE

5 6

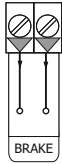

Power free (contact) or 230V, depending on model.

**FLASH
230V**

11 12

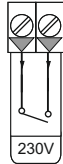

**OPENED
DOOR**

13 14

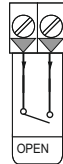

**CLOSED
DOOR**

15 16

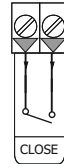

**LIMIT
SWITCHES**

17 18 19

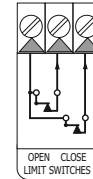

AUTOTEST

20

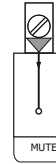

SAFETY EDGE

21 22 21 22

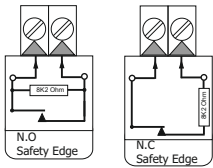

**OPEN
SAFETY**

21 22

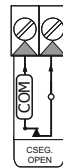

**CLOSE
SAFETY**

23 24

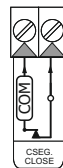

**PUSH
BUTTONS**

25 26 27 28

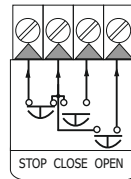

**ACCESSORIES
POWER SUPPLY**

29 30 31 32

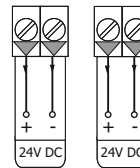

**DIGITAL
ENCODER**

33 34 35 36

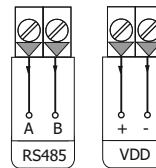

**INTERMEDIATE
STOP**

37 38

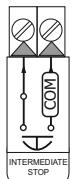

3.3 LOOP DETECTOR



**WITHOUT
LOOP
DETECTOR**



**WITH
LOOP
DETECTOR**

4. DIGITAL TIME PROGRAMMING

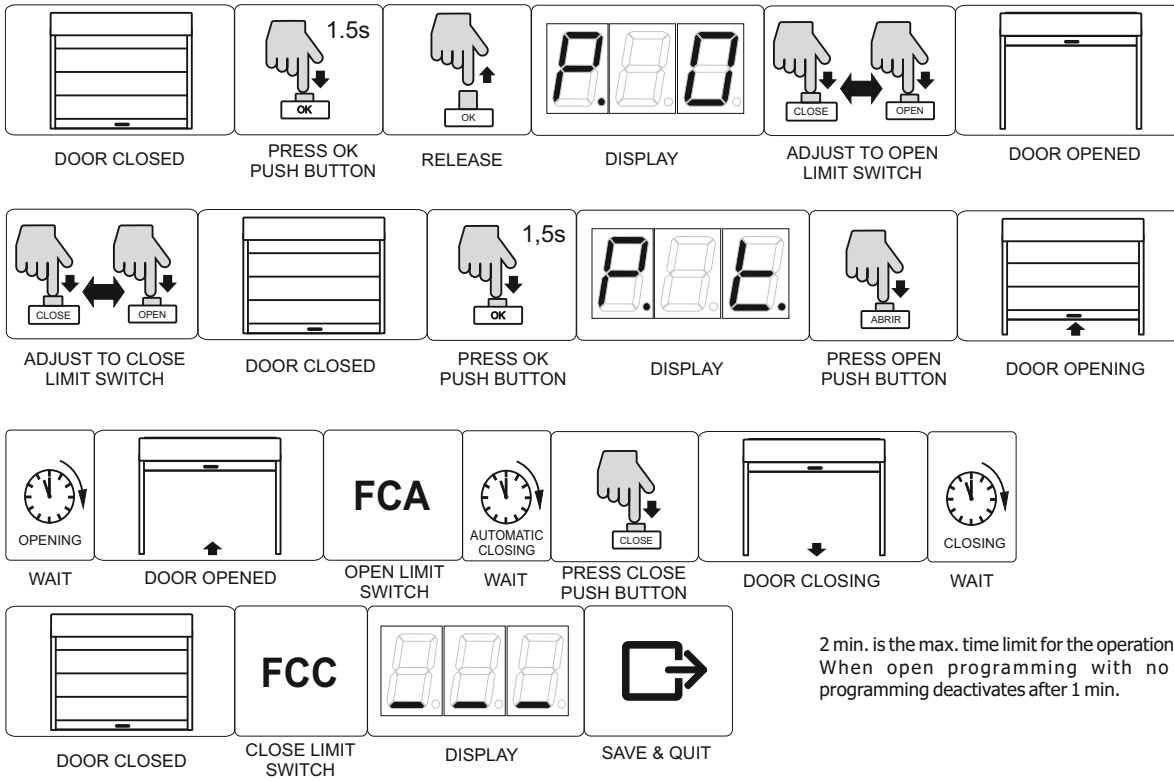

2 min. is the max. time limit for the operation.
When open programming with no manoeuvre, programming deactivates after 1 min.

5. ENCODER TIME PROGRAMMING (select encoder type e.1)

- Reset (always before programming process):

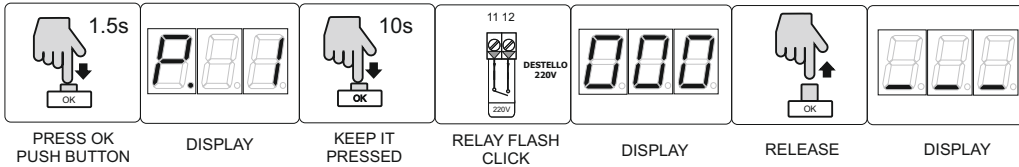

- Programming process:

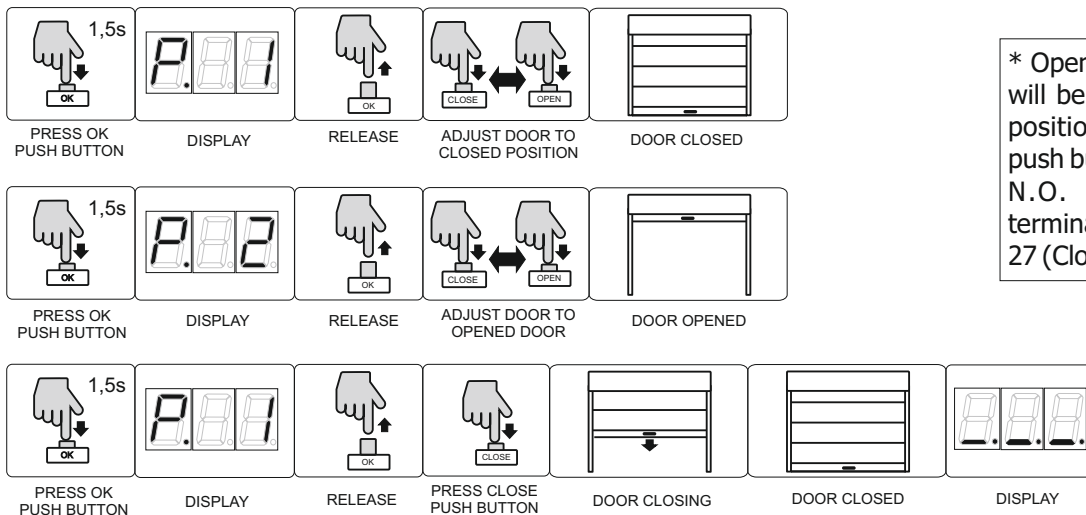

* Open and Close push buttons will be used to adjust the door position. If there aren't any push button connected, connect N.O. push buttons to the terminals 26-28 (Open) and 26-27 (Close).

*** Important:** Once encoder position is memorized, carry out 3 complete manoeuvres to compensate possible door imbalance.

5.1 INTERMEDIATE STOP TIME PROGRAMMING (WITH ENCODER)

Set parameter e.2 = 1:

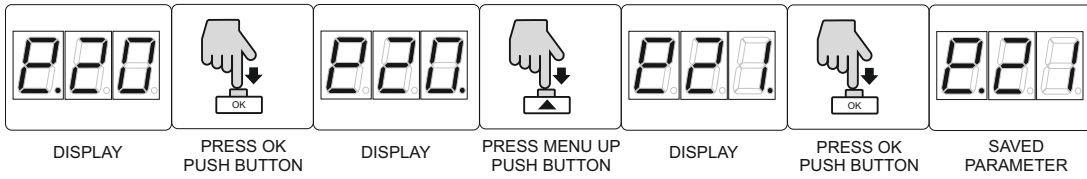

Back to parameter e.2 to begin the intermediate stop time programming:

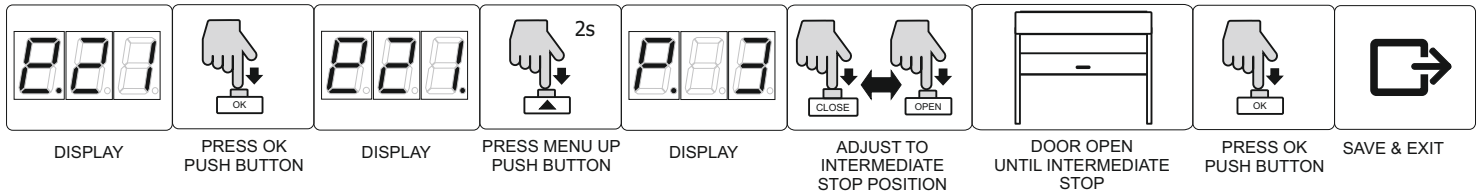

5.2 INTERMEDIATE STOP CONNECTIONS (WITHOUT ENCODER)

Set parameter e.2 = 1:

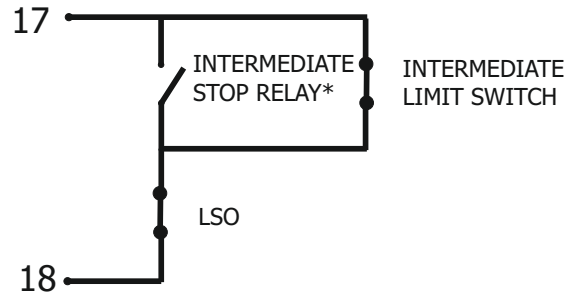
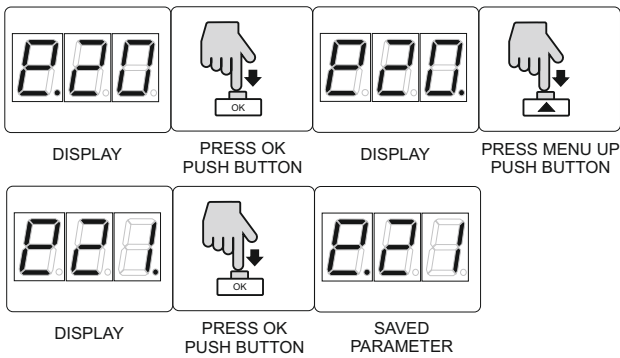

*Assigned with option e.3

5.3 DISABLE PHOTOCELL AT OPENING PROGRAMMING PROCESS (WITH ENCODER)

Set parameter e.5 = 1:

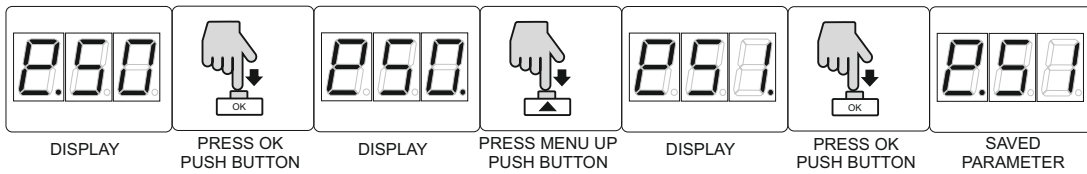

Back to parameter e.5 to begin the disable photocell start position programming:

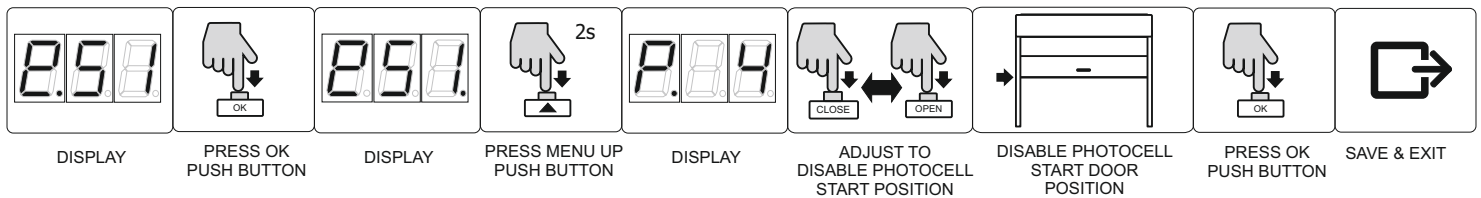

6. INTERLOCK FUNCTION

- Prevent two doors from being opened at the same time

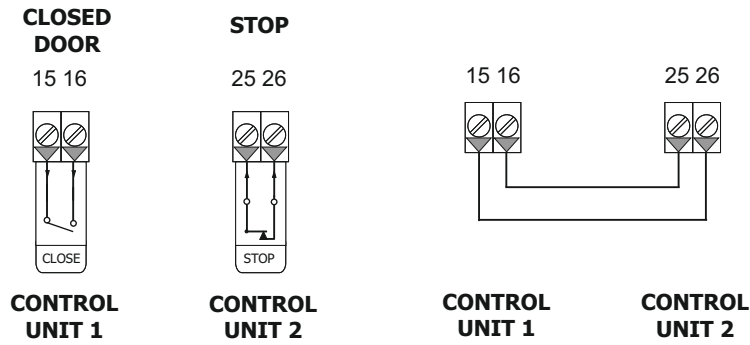

7. HOUSING

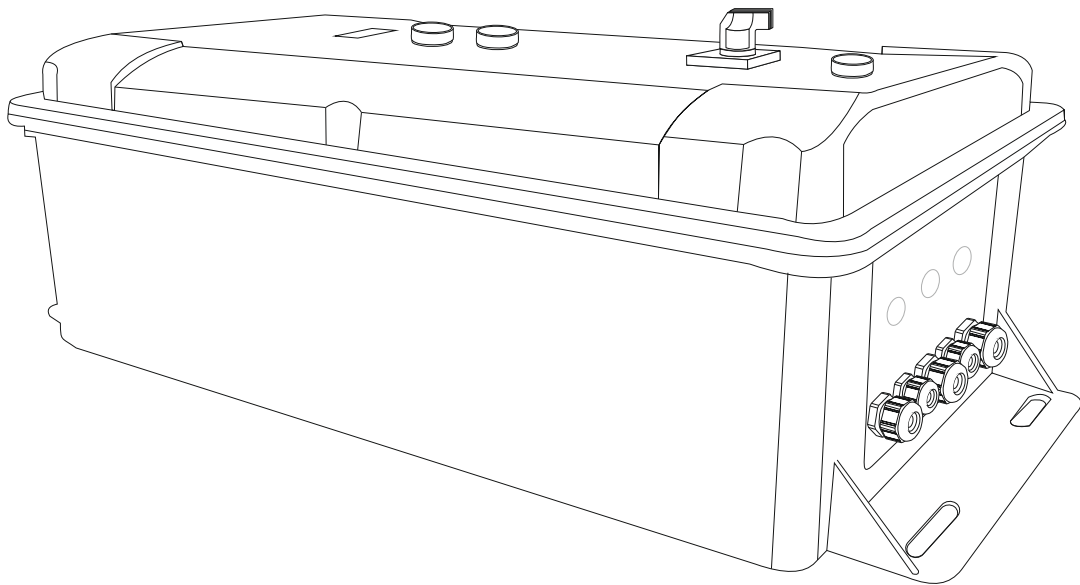

8. MENU

8.1 ENTER TO MENU MODE

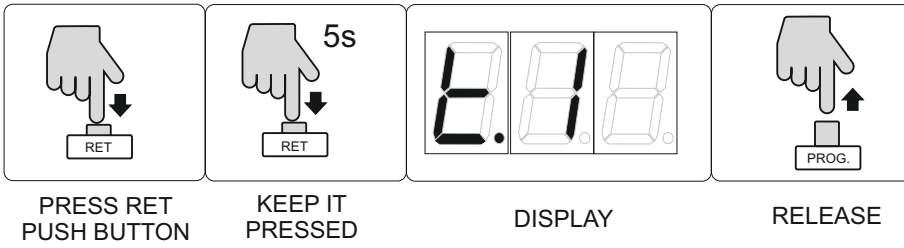

8.2 MENU ORGANIZATION

Navigation:

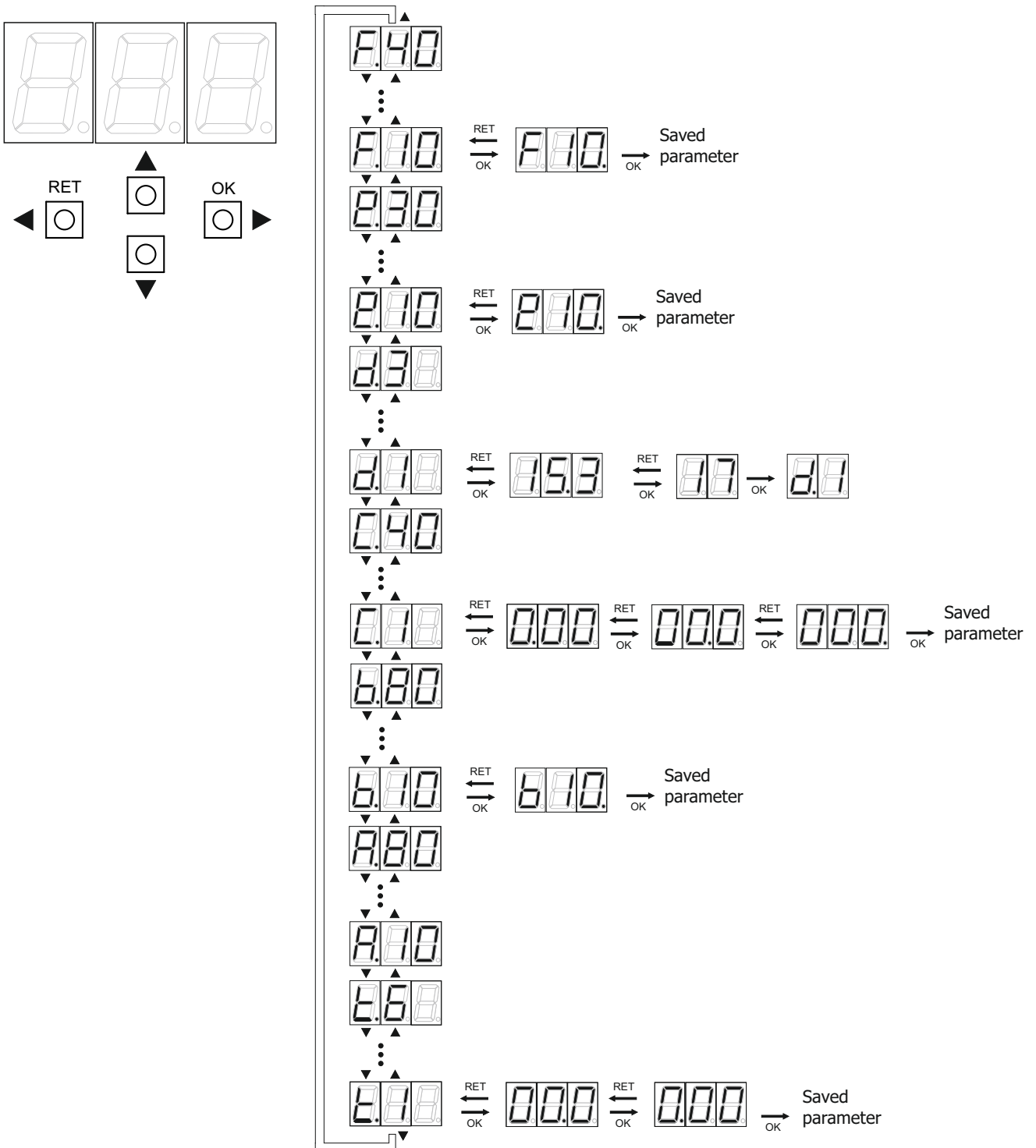

9. MENU PARAMETERS SET UP

9.1 TIMES (t._)

Automatic closing time:

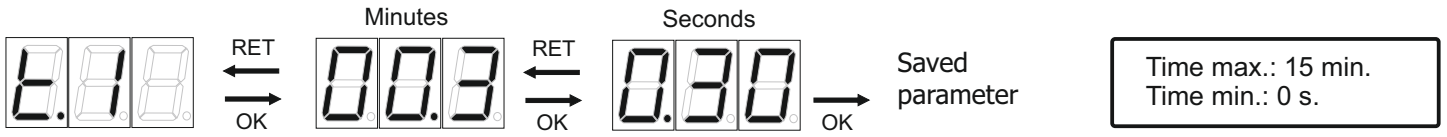

Opening time:

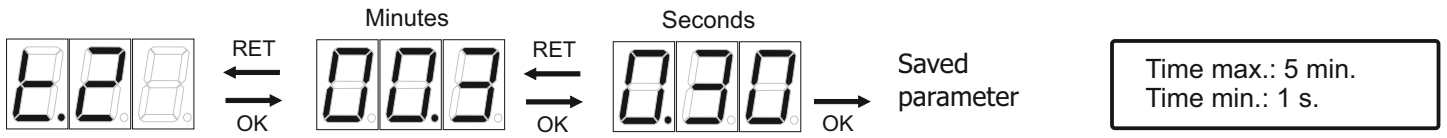

Closing time:

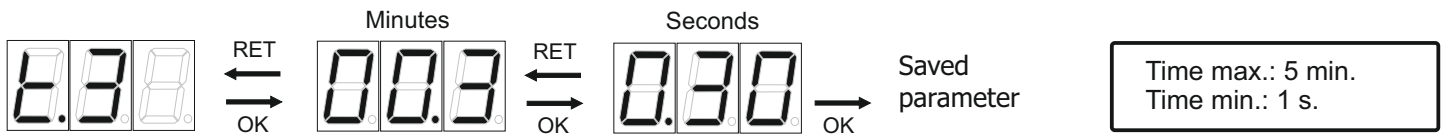

Invert time:

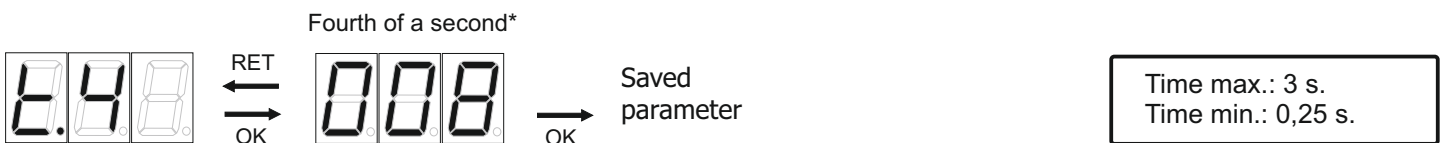

*Every unit represents 0.25 seconds.

9.2 FUNCTIONS (A._)

Open push button (26-28):

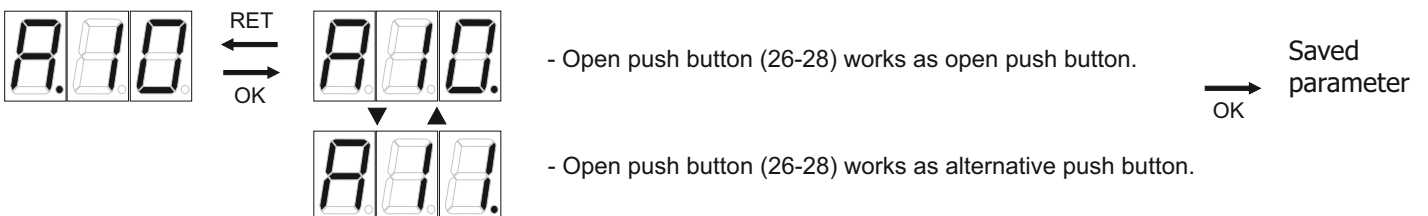

Disabling stop when opening:

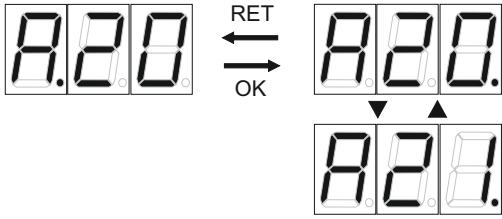

- No.

- Yes.

→ Saved parameter
OK

Dead man:

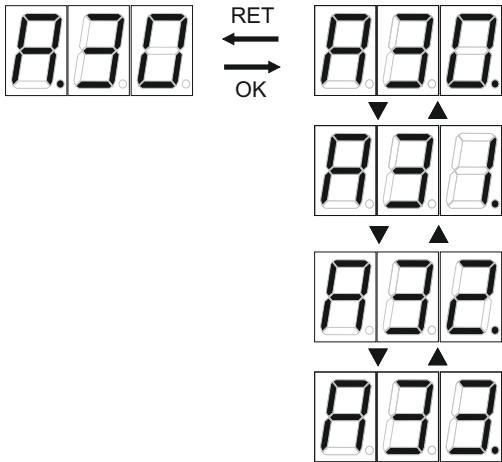

- Never.

- When closing.

- When opening.

- Always.

→ Saved parameter
OK

Photocell for opening (21-22):

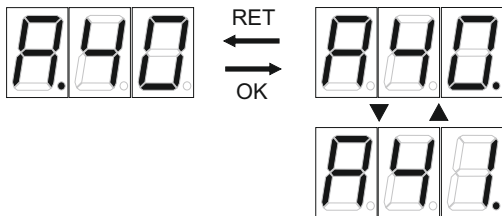

- Stop the manoeuvre.

- Stop and go the manoeuvre.

→ Saved parameter
OK

Resistive safety edge when opening:

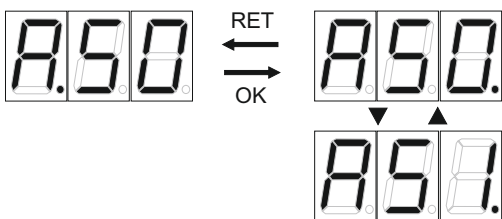

- Stop and invert when closing.

- Stop and invert 1 second when closing.

→ Saved parameter
OK

Resistive safety edge when opening:

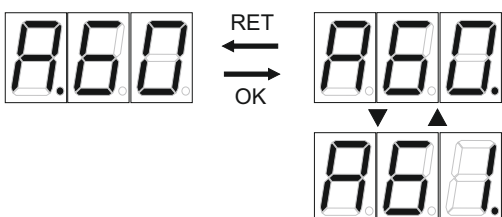

- Nothing.

- Stop and invert 1 second when opening.

→ Saved parameter
OK

Photocell 1 / Safety Edge input (21-22):

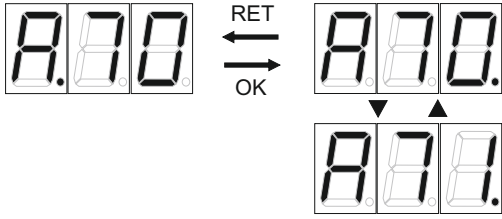

- Works as a photocell when opening.
- Works as 8K2 safety edge.

→ Saved parameter
OK

Door contacts indicator:

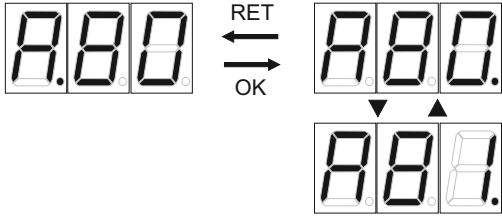

- Normally open (N.O.).
- Normally closed (N.C.).

→ Saved parameter
OK

9.3 FUNCTIONS (B._)

Photocell when door open (23-24):

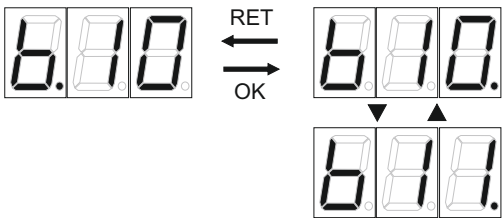

- Restore automatic closing time deactivated.
- Restore automatic closing time.

→ Saved parameter
OK

Open push button when door open (26-28):

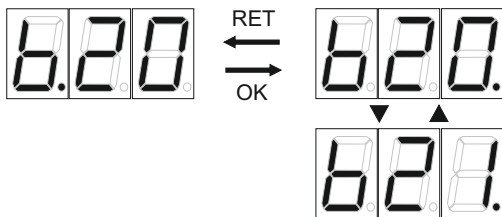

- Restore automatic closing time deactivated.
- Restore automatic closing time.

→ Saved parameter
OK

Activation resistive edge (8K2) / mechanical (NC) (29-30):

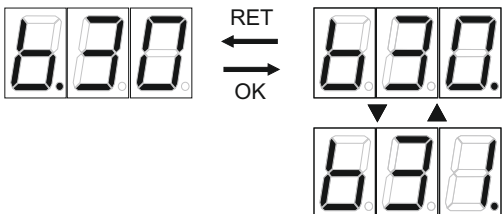

- Restore automatic closing time deactivated.
- Restore automatic closing time.

→ Saved parameter
OK

Activation safety edge input (29-30):

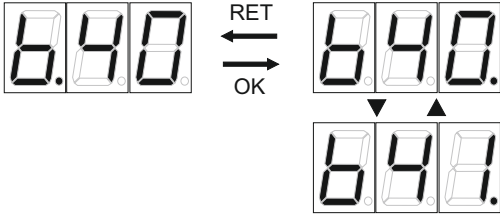

- Restore automatic closing time deactivated.
- Restore automatic closing time.

→ OK Saved parameter

Closing for photocell (31-32):

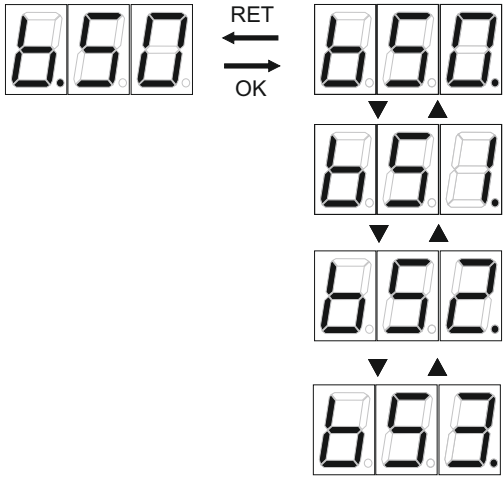

- No.
- Immediate.
- 3 seconds delay.
- Reserved.

→ OK Saved parameter

Photocell inhibition when closing:

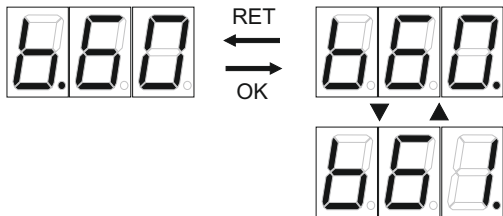

- No.
- Yes.

→ OK Saved parameter

Photocell inhibition when opening:

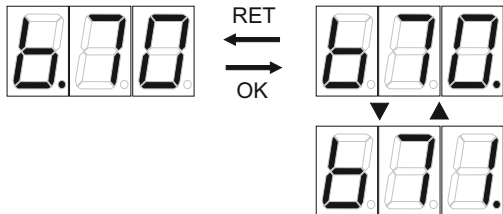

- No.
- Yes.

→ OK Saved parameter

Photocell test:

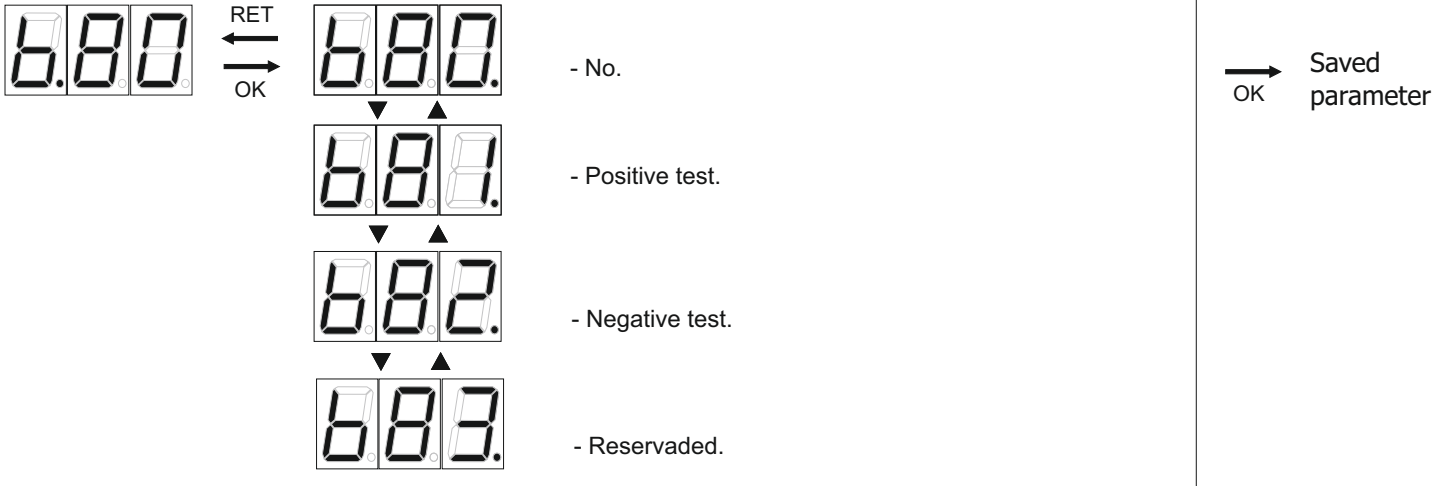

9.4 MAINTENANCE (C._)

Cycle limit for maintenance:

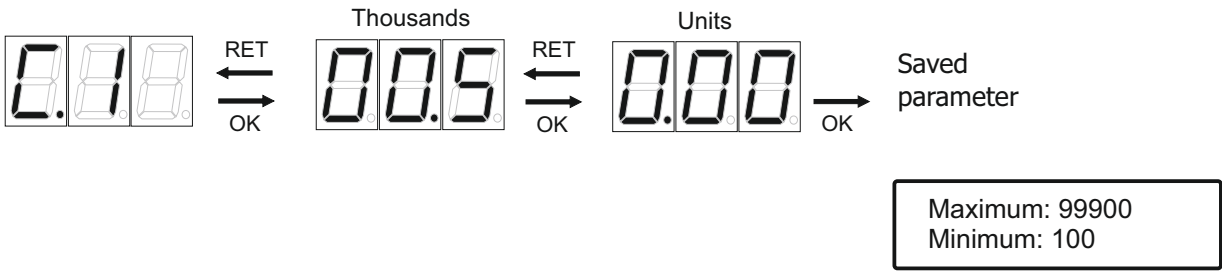

Cycle counter trip:

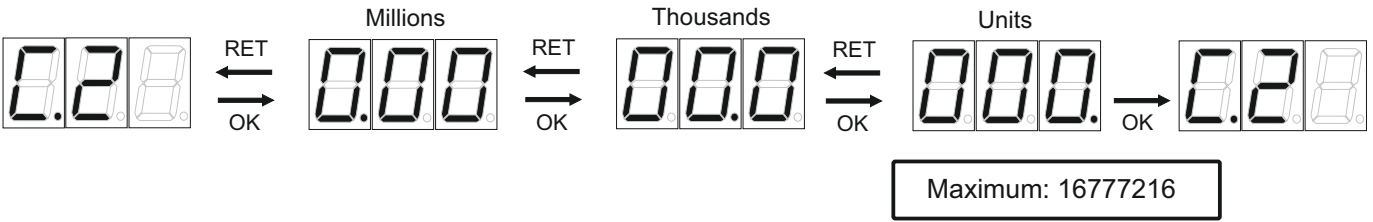

Reset counter:

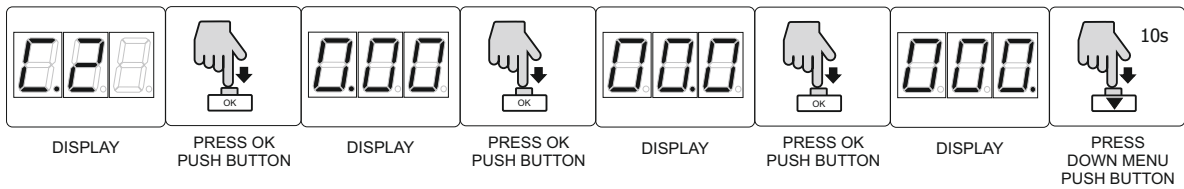

Total cycle counter:

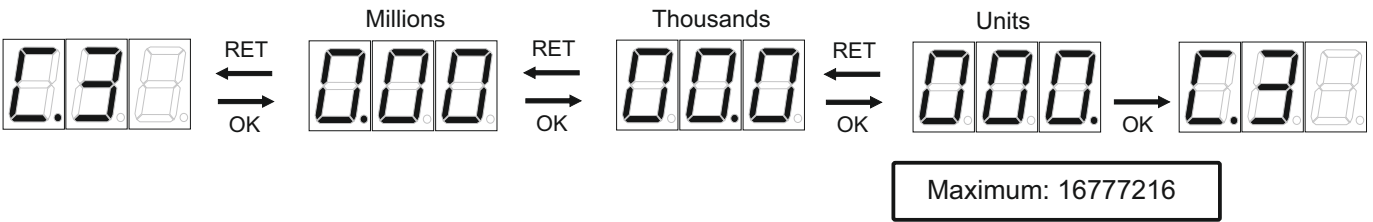

Maintenance warning:

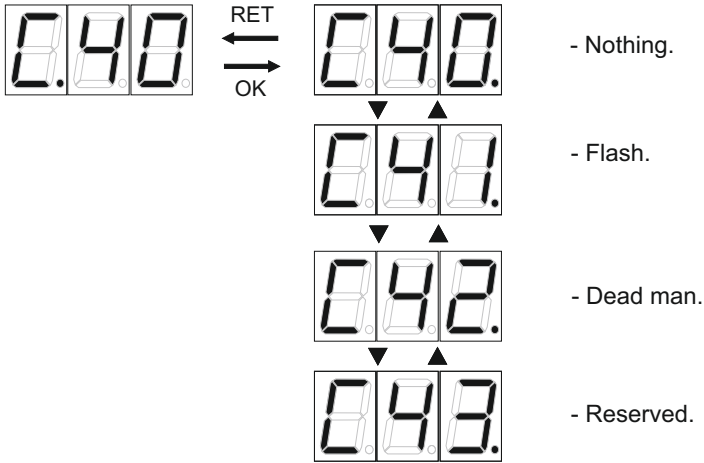

→ OK Parámetro guardado

9.5 CONTROL UNIT INFORMATION (d._)

Production date:

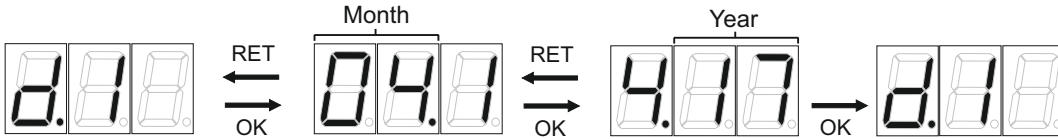

Last maintenance date:

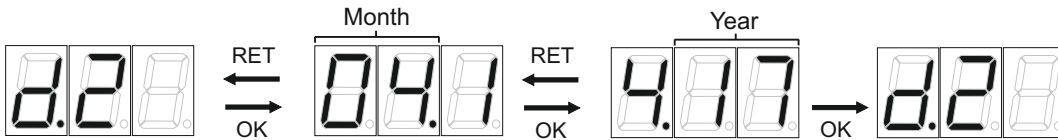

Software version:



9.6 ENCODER (e._)

Absolute encode type:

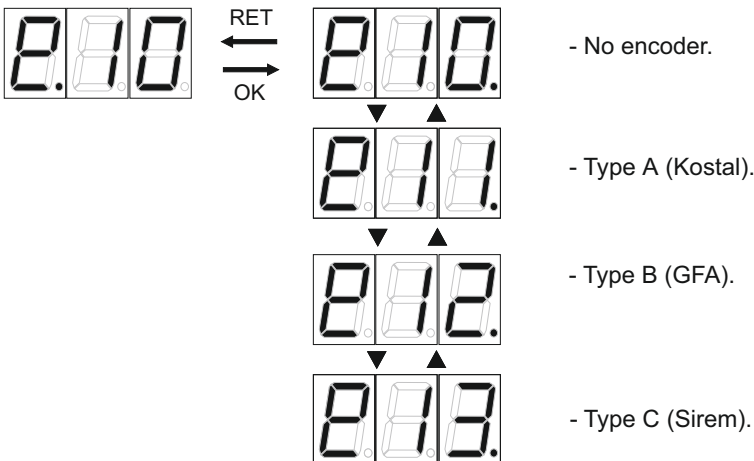

→ OK Saved parameter

Intermediate stop setup:

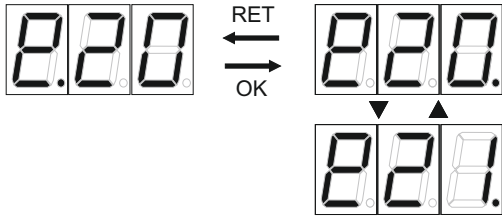

- No.
- Yes, memorize.

→ OK Saved parameter

Intermediate stop option:

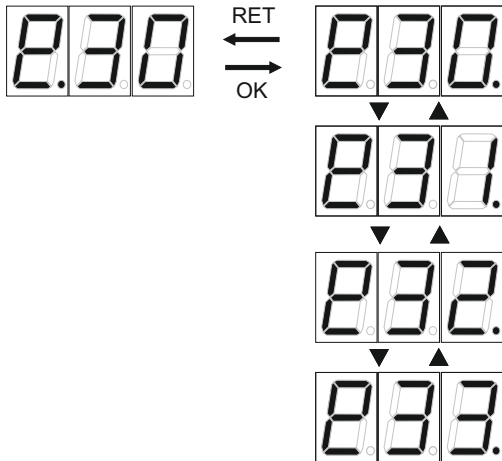

- No.
- Relay 3.
- Relay 4.
- Reserved.

→ OK Saved parameter

Disable photocell at opening:

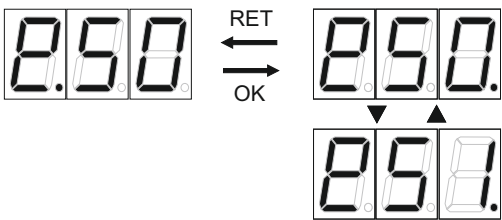

- No.
- Yes.

→ OK Saved parameter

Limit Switch Close (LSC) fine adjustment:



- Fine adjustment from -7 to 7. **Negative** value to adjust before and **positive** value to adjust after the programmed LSC.

→ OK Saved parameter

Limit Switch Open (LSO) fine adjustment:

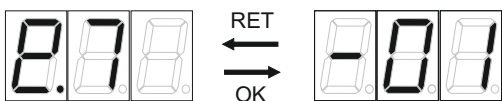

- Fine adjustment from -7 to 7. **Negative** value to adjust before and **positive** value to adjust after the programmed LSO.

→ OK Saved parameter

9.7 FLASH (F._)

Flash when door opening:

RET
←
OK →

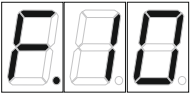
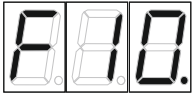
  - No.

↓ ↑

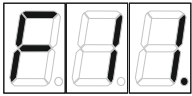
 - Yes.

↓ ↑

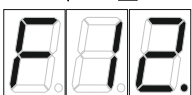
 - Turn signal.

↓ ↑

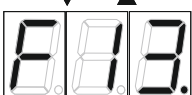
 - Reserved.

→ OK Saved parameter

Flash door opened:

RET
←
OK →

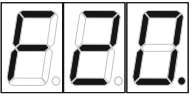
  - No.

↓ ↑

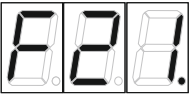
 - Yes.

↓ ↑

 - Turn signal.

↓ ↑

 - Reserved.

→ OK Saved parameter

Flash door closing:

RET
←
OK →

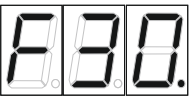
  - No.

↓ ↑

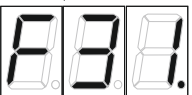
 - Yes.

↓ ↑

 - Turn signal.

↓ ↑

 - Reserved.

→ OK Saved parameter

Pre-flashing option:

RET
←
OK →

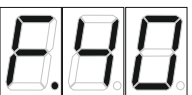
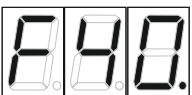
  - No.

↓ ↑

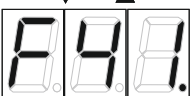
 - Yes.

→ OK Saved parameter

9.8 ERRORS (E..)

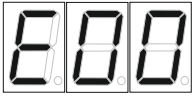

- Limit switches common error.

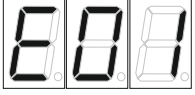

- Photocell open / edge error (21-22).

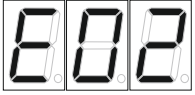

- Photocell close error (23-24).

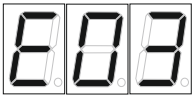

- Loop detector error.

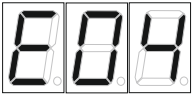

- Stop (25-26) error.

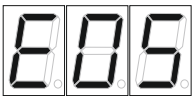

- Cover stop push button error.



- Safety edge activated (via radio) error.

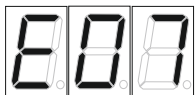

- Open push button error (26-28).



- Close push button (26-27).

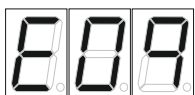

- Encoder error (no answer).

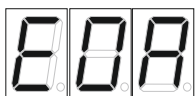

- Phase shift error (encoder).



- Limit position NOT saved.
*for digital time programming please see point 5

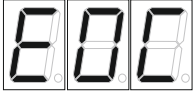

- Communication error (encoder).

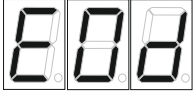

- Door maintenance notice. Reset with parameter C2.

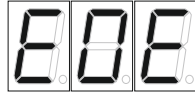

- Photocell / edge test error.

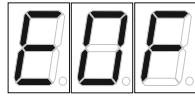

- Encoder error (magnet not detected).

TECHNICAL SPECIFICATIONS

Power Supply	380/220V AC +/- 10%
Drive	220V / 380V 3HP
Max Drive Power	1.5HP / 3HP
Power Supply for accessories	12V DC 250mA / 24V DC 250mA
Garage door output type	Power free contact
Flashing light output	220V 10A
Working Time	From 8 sec to 80 sec
Automatic closing time	From 5 sec to 120 sec
Radio Card	Optional
Loop Detector Card	Optional
Photocell inhibitor Card	Optional
NFC card	Optional
Working Temperature	-20 to 50°

CE DECLARATION OF CONFORMITY
For more information visit the website www.aerf.eu

WARNING!!

- Equipment installation and start-up, can only be executed by qualified personal.

