



## 1. APLICATIONS

Control unit designed for wings and wings two leave doors at 230 Vac, electromechanic motors or hydraulics without limit switch.

## 2. OPERATING INSTRUCTIONS

The control unit maneuvers are executed with OPEN or ALTER push buttons and if is used, with the transmitters push buttons.

The maneuvers ends when finishes the operation time.

STOP activation causes the immediate stop of the maneuver, requiring an order for resume it.

On closing, the C.SEG activation inverts the maneuver, opening the doors.

Engine power is regulating by POWER potentiometer. This action is applied after 2 seconds the maneuver has been initiated.

Suspension time (selected in the working time programme) is the time before finishing the manoeuvre that the engine will work in suspension mode. In POWER SLOW we can select engine speed in suspension period when OPTION 7 is ON.

## 3. CONNECTIONS

### 3.1 POWER SUPPLY & MOTOR CONNECTIONS

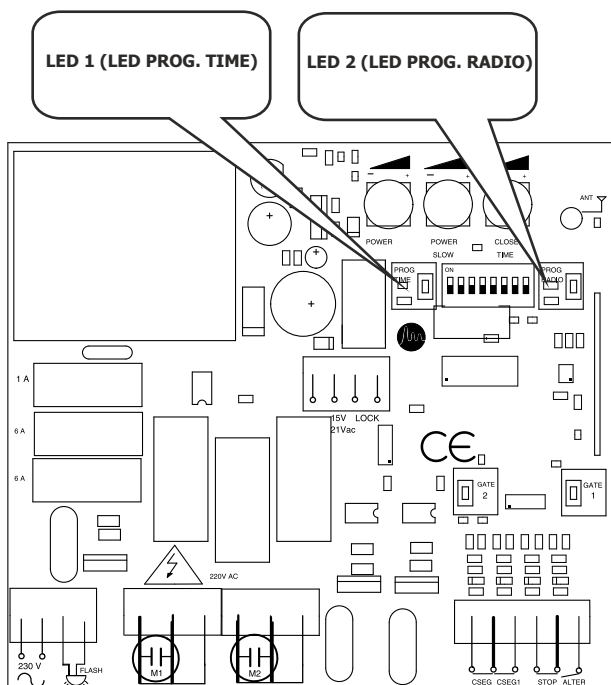

#### POWER SUPPLY

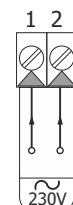

#### MOTOR 1

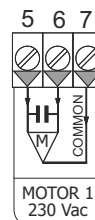

#### MOTOR 2

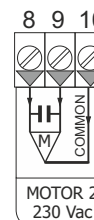

### 3.2 TERMINAL CONNECTIONS

#### FLASH

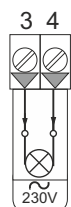

#### SAFETY CONTACT

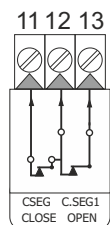

#### TERMINAL BUTTONS

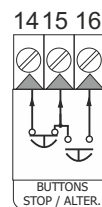

#### ACCESSORY POWER SUPPLY

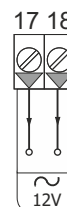

#### ELECTRO-LOCK

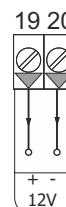

## 4. POTENTIOMETERS

### POWER (RED)



Regulates engine power.  
Rotate to LEFT to decrease and rotate to RIGHT to increase.

### POWER SLOW (GREEN)



Soft Stop Motor regulation.  
Only with OPTION 7 ON.

















Rotate to LEFT to decrease and rotate to RIGHT to increase.

### AUTOMATIC CLOSING TIME (BLUE)



Regulates the waiting time before the automatic close. Turn LEFT to decrease and RIGHT to increase.  
Minimum - 3 seg.  
Maximum - 120 seg.

## 5. OPTIONS

1	AUTOMATIC CLOSING		- Doors closes automatically.
			- Door does not close automatically.
2	DISABLE STOP OPENING		- The ALTER button (15-16), transmitter or GATE 1 button, can't stop the door on opening.
			- Door stops on opening with transmitter, GATE 1 or ALTER (15-16) buttons.
3	RADIO PROGRAMMING		- Not allowed.
			- Allowed.
4	INVERSION SHUT		- Before opening, the electro lock and closure relay are activated.
			- Normal opening with electro lock.
5	OPEN SECURITY CONTACT (C.SEG1)		- C.SEG1 input (11-12), stops and inverts 2 sec. the opening maneuver. On closing, stops & inverts the maneuver.
			- C.SEG1 input (11-12) stops the opening maneuver. When C.SEG1 is deactivated, the door open again.
6	FLASHING LIGHT		- Flashing.
			- Fixed.
7	SOFT STOP		- At the end of opening and closing manoeuvre, the door does a soft stop. (with option 8 ON, does a impulse every 3 hours.)
			- Without soft stop.
8	HYDRAULIC DRIVE		- Engine power always maximum and without soft stop.
			- Normal engine operation.

## 6. PROGRAMMING A TRANSMITTER

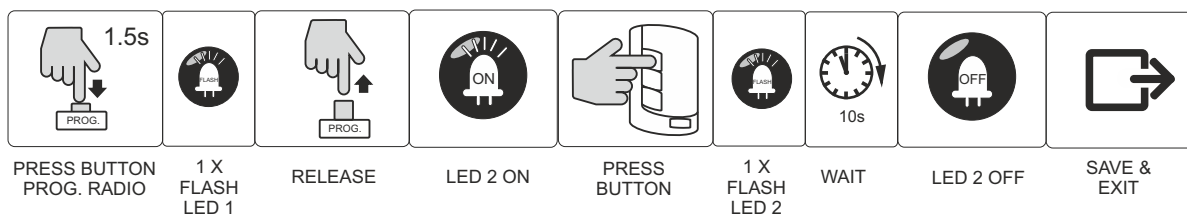

### 6.1 TRANSMITTER RADIO PROGRAMMING

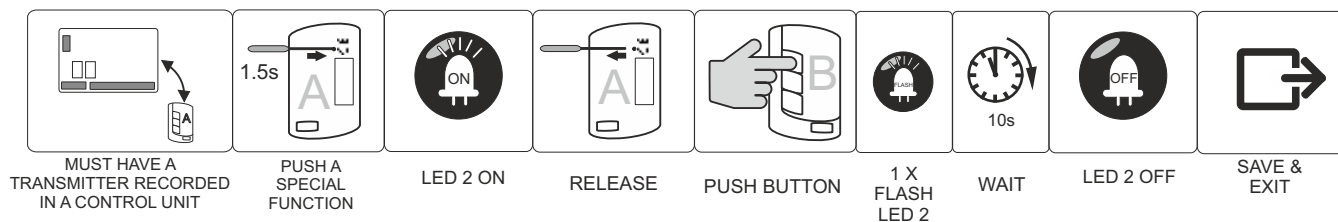

### 6.2 MEMORY RESET

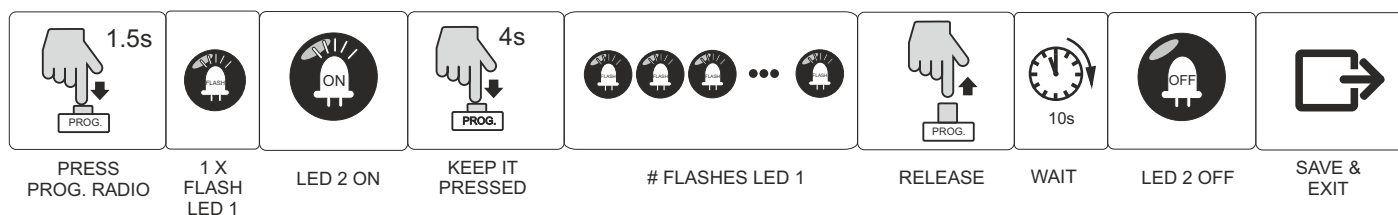

## 7. TRANSMITTER PEDESTRIAN CHANNEL PROGRAMMATION

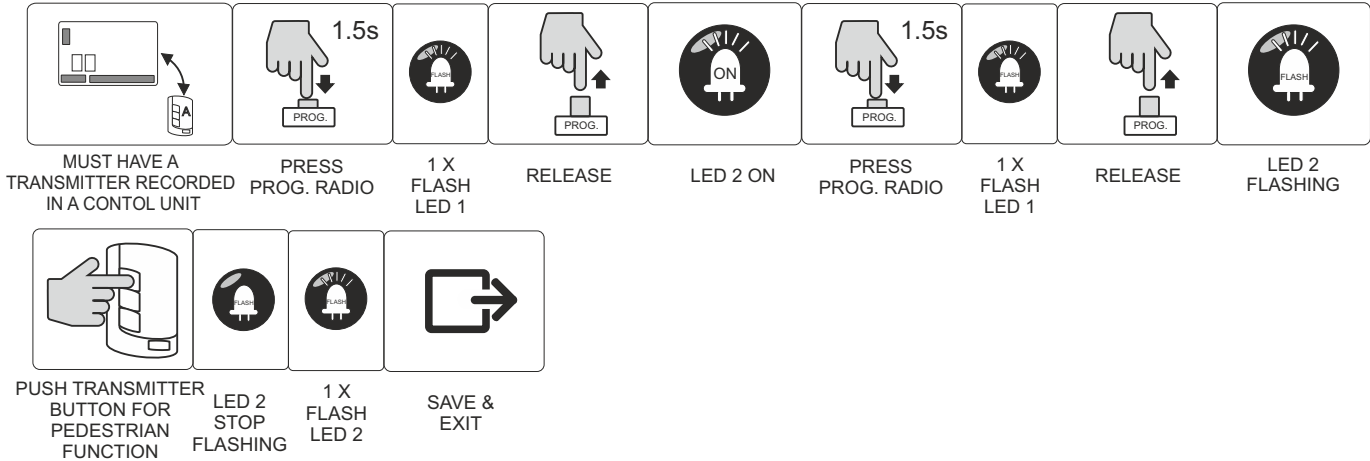

## 8. DIGITAL TIME PROGRAMMING for working and automatic closing.

### OPENING PROGRAMMATION

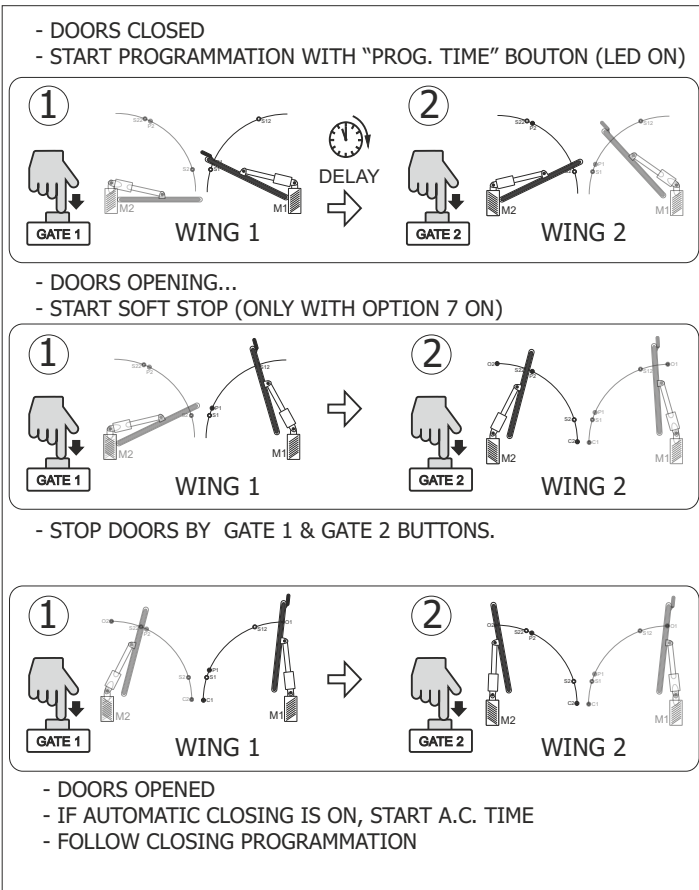

### CLOSING PROGRAMMATION

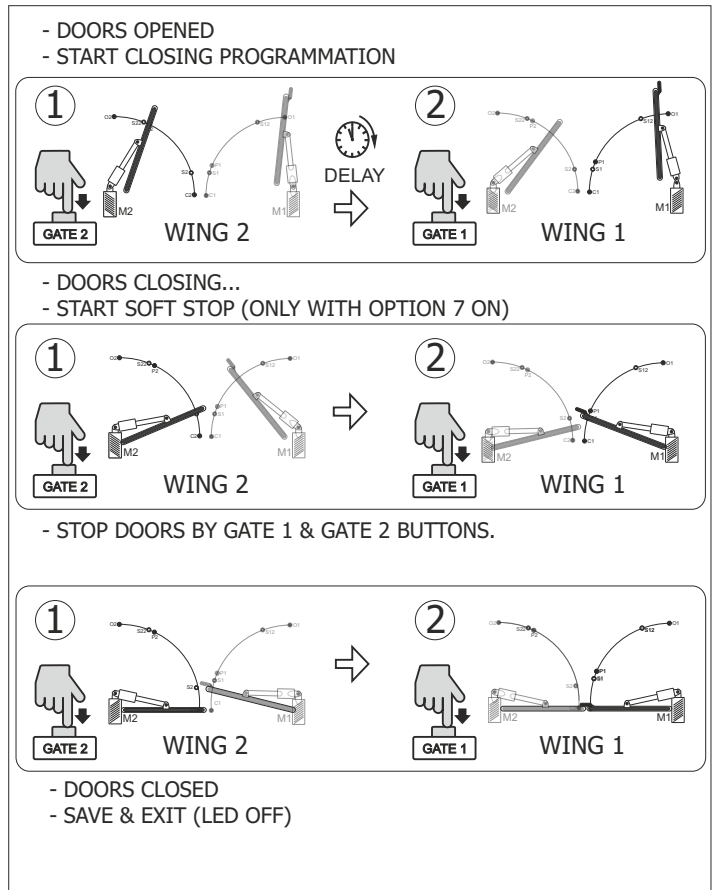

IF IS USED ONLY ONE MOTOR, MAKE THE PROGRAMMING PROCESS WITH GATE 1 BUTTON.

## 9. BOX HOUSING

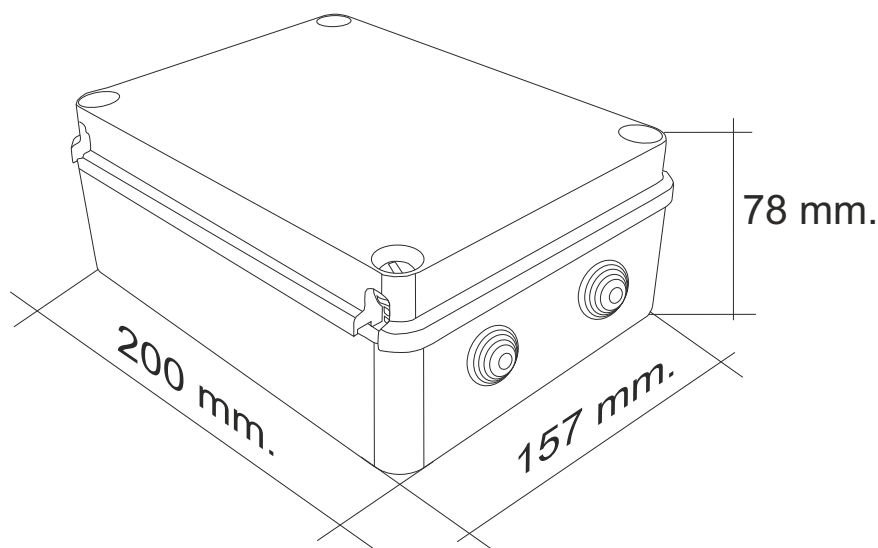

## TECHNICAL SPECIFICATIONS

Alimentation	230V AC +/- 10%
Motor Power	550 W (0.74 HP)
Accessory alimentation output	12V AC/DC 250mA
Automatic closing time	5 seg a 2 min
Working time	Max. 2 min
Code Combinations	72.000 Billions of codes /4000 binary
Number of Codes	255 codes
Code Programming	Automatic learning
Function Selector	Transmitter memorized
Garage Light Time	3 min.
Garage Light Contact	10 A a 230V
Frequency	433,92 Mhz (868 Mhz)
Normative	Conforms to ETS 300-220/ETS 300-683
Sensibility	Better than -100dBm
Range	Max. 60 m
Antenna	Built in
Working Temperature	-20 to 85°C

CE DECLARATION OF CONFORMITY  
For more information visit the website [www.aerf.eu](http://www.aerf.eu)

**WARNING!!**

- Equipment installation and start-up, can only be executed by qualified personal.

