

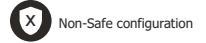

(KIT WIRELESSBAND 2R)

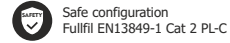

1. GENERAL

Two channel wireless system communication for either resistive or mechanical safety edges.

1.1 SAFETY INDICATIONS

- Reaction time < 60ms (according TÜV test report AV86368T Certificate n° M6A 0908000001 Rev. 01)
- EN13849-1-2015 Cat2 PL-C with TEST.

2. TRANSMITTER REGULAR CONFIGURATIONS

2.1 INDUSTRIAL SECTIONAL DOOR (1 TRANSMITTER 2 CHANNELS)

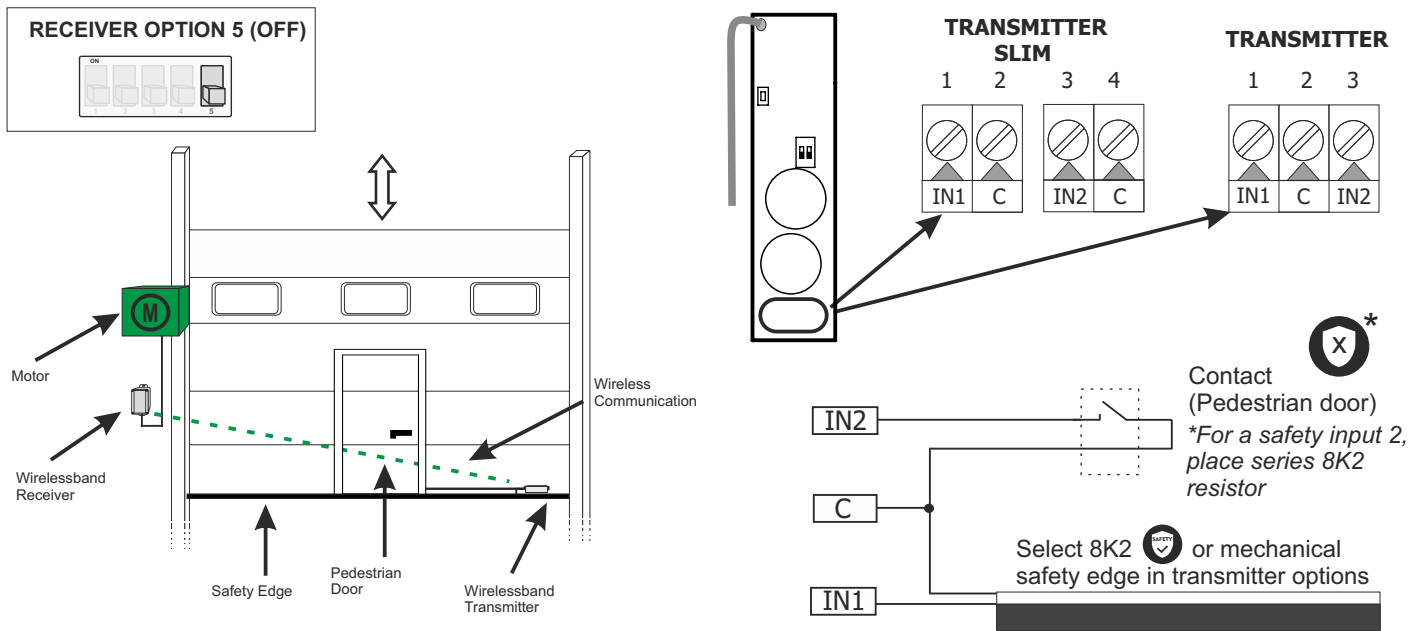

2.2 SLIDING GATE (TRANSMITTER 1 CHANNEL 1, TRANSMITTER 2 CHANNEL 2)

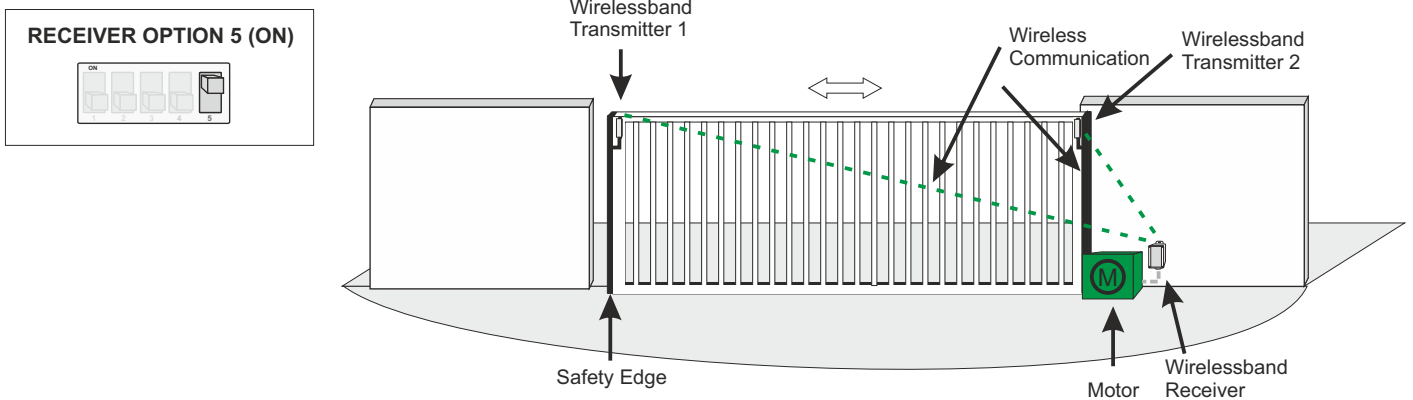

TRANSMITTER 1

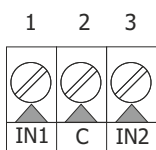

TRANSMITTER 1 SLIM

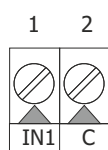

TRANSMITTER 2

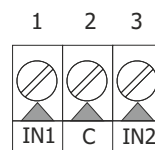

TRANSMITTER 2 SLIM

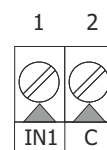

2.3 TRANSMITTER OPTIONS SELECTOR

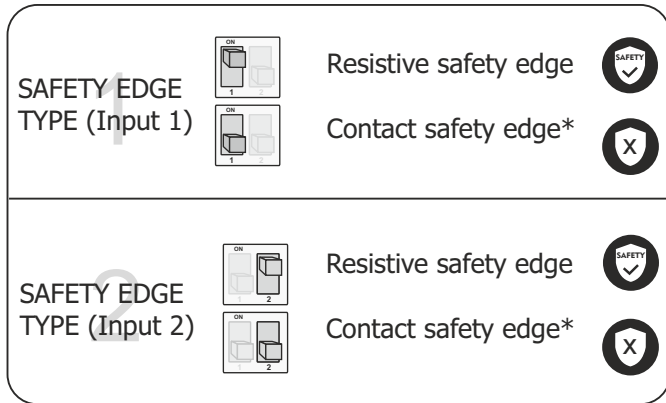

* To change from NO to NC, follow point 2.5

2.4 TRANSMITTER OPTIONS COMBINATION

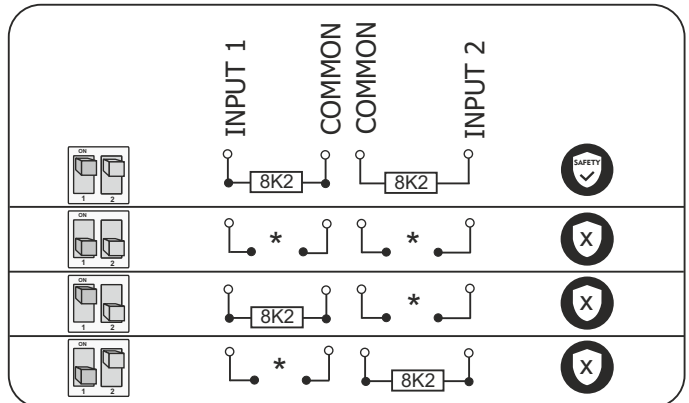

* To change from NO to NC, follow point 2.5

2.5 SAFETY EDGE INPUT TYPE SELECTION N.C. or N.O.

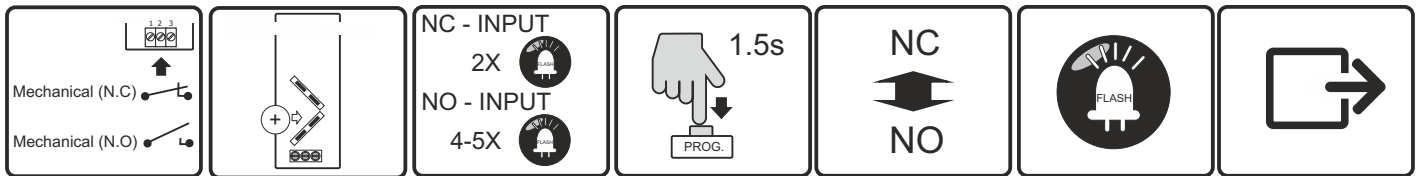

1. CONNECT SAFETY EDGE TO TRANSMITTER
2. INSERT BATTERY
3. STATUS INDICATION (DEFAULT NO)
4. PRESS TRANSMITTER FOR CHANGE STATUS
5. STATUS CHANGE
6. LED FLASH
7. SAVE & EXIT

You have 5 seconds after battery connection to make the change of safety edge status. If you want to change again the status, please remove and connect batteries again.

3. RECEIVER

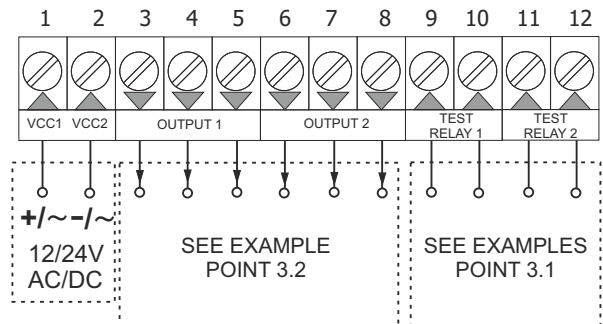
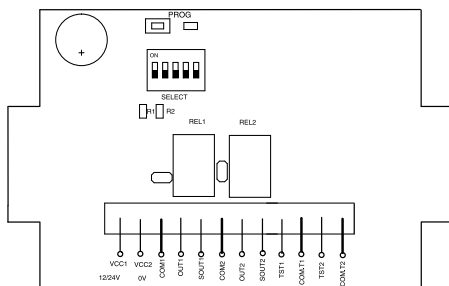

3.1 RECEIVER CONNECTION EXAMPLES (TEST* RELAY)

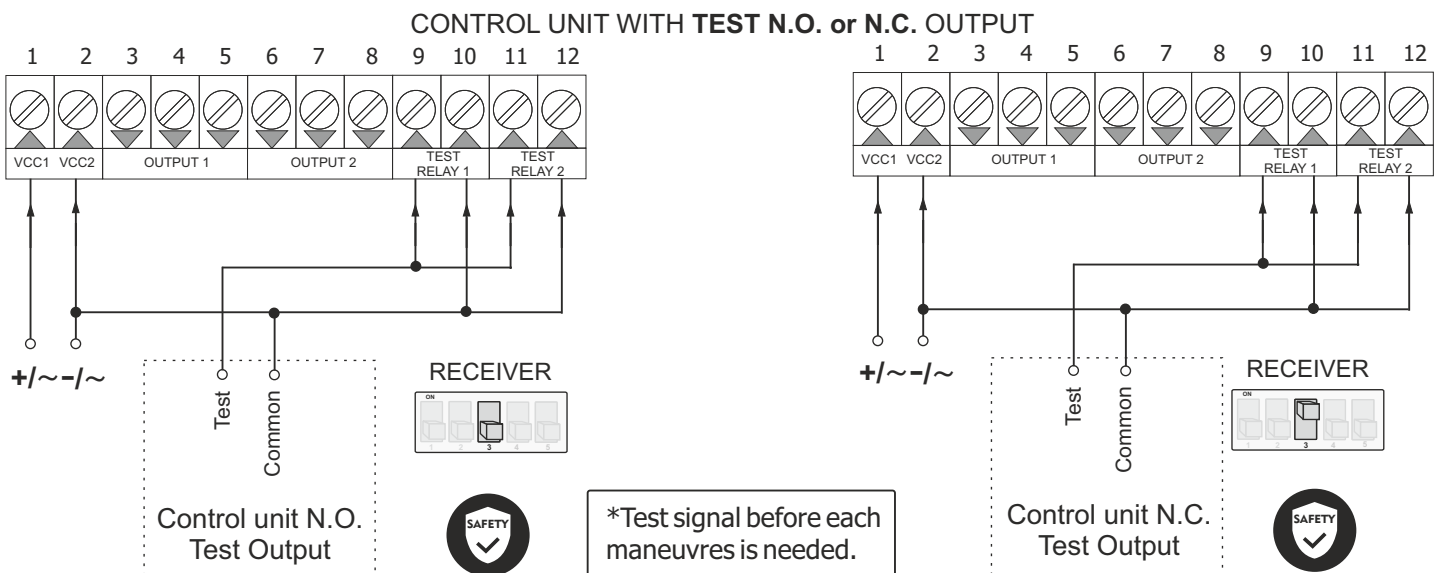

3.2 RECEIVER OUTPUT CONNECTIONS

Normal conditions, safety edge deactivated.		Fail / Sensor active / Sensor not memorized	
			 WITH BRIDGE SELECTOR <i>*Only 3-4 & 6-7 outputs</i>
			 WITHOUT BRIDGE SELECTOR

3.3 RECEIVER LED INDICATOR



LED ON - Security OK



LED OFF - Obstacle detected

3.4 RECEIVER OPTIONS SELECTOR

CLASS 2		Enabled (UNE- EN 13849-2)
		Disabled*
TRANSMITTER FREQUENCY		869,85 MHz
		868,95 Mhz*
RELAY TEST TYPE		N.C. contact
		N.O. contact*
AUTOMATIC FREQUENCY AGILITY		Enable
		Disable*
TRANSMITTER TYPE		1 CHANNEL
		2 CHANNEL*

* Default options

4. START-UP

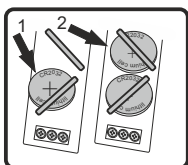

1. INSERT BATTERIES

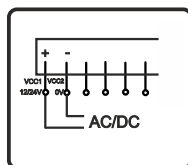

2. CONNECT RECEIVER POWER SUPPLY

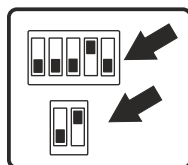

3. CHECK OPTION SELECTORS

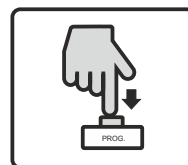

4. CARRY OUT PROGRAMMING PROCESS (POINT 5.)

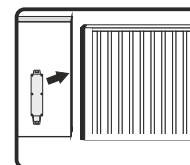

5. INSTALL AND WIRE TRANSMITTER

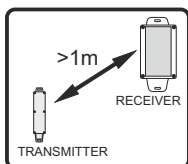

6. MINIMUM DISTANCE 1 m.

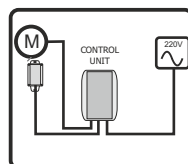

7. INSTALL AND WIRE RECEIVER

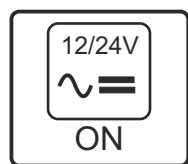

8. TURN ON POWER SUPPLY

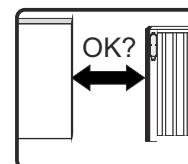

9. TEST SAFETY EDGE

5. PROGRAMMING PROCESS

CODE MEMORIZATION 1 TRANSMITTER FOR 2 CHANNELS (DIP-SWITCH 5 - OFF)

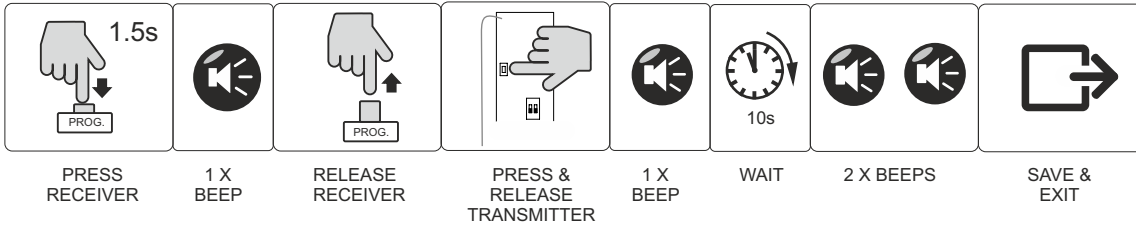

In Kits, receiver and transmitter are already paired.

RECEIVER OPTION 5 (OFF)



CODE MEMORIZATION TRANSMITTER 1 FOR CHANNEL 1 (DIP-SWITCH 5 - ON)

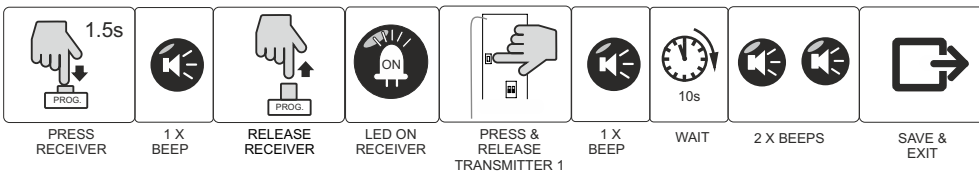

RECEIVER OPTION 5 (ON)



CODE MEMORIZATION TRANSMITTER 2 FOR CHANNEL 2 (DIP-SWITCH 5 - ON)

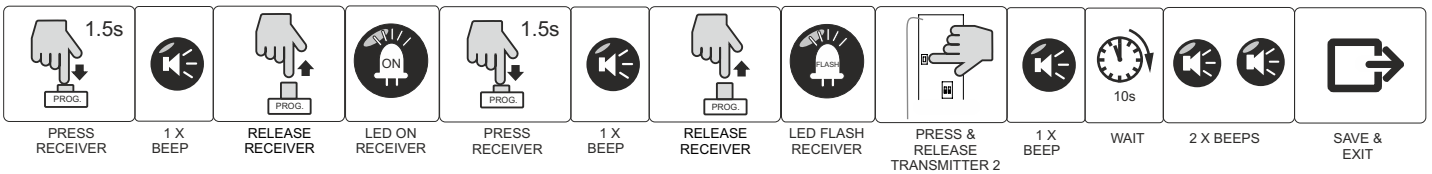

TRANSMITTER 1

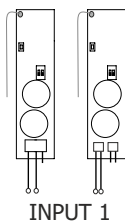

TRANSMITTER 2

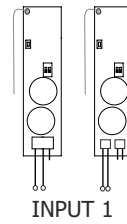

RECEIVER

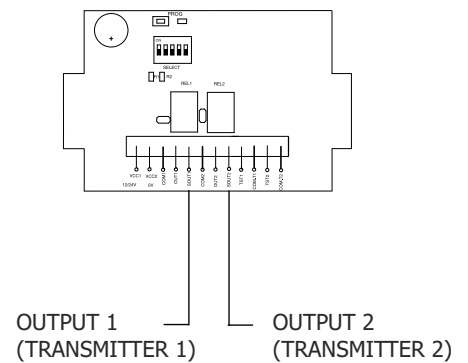

5.1 MEMORY RESET



MEMORY FULL INDICATOR

Several beeps for 10 seconds when trying to memorize a new transmitter.

LOW BATTERY INDICATOR

4 beeps each time a message is received from a programmed transmitter. Both, warning LED and buzzer are activated simultaneously. Battery 1 and 2 should be insert in that order. When replacing batteries, there's no need to program the transmitters again.

6. NOTES

TECHNICAL SPECIFICATIONS

Receiver supply voltage	12/24 AC/DC SELV/PELV
Transmitter supply voltage	2x lithium battery 3V DC type CR2032
Battery life	2 years
Receiver memory	7 transmitters for each channel
Receiver Output	2 - Relay, micro disconnection 1B or power free contact
Receiver Power consumption	0.5 W - 12 V / 1,2 W - 24 V
Ball pressure test (IEC 695-10-2)	PCB (125°C) WRAP (75°C)
Pollution degree	2
Protection class (IEC 60529)	Ip55
Frequency Channels	868.95MHz & 869.85MHz
Range	100m
Working temperature	-35°C to +55°C
Rated transient over voltage	330V
Transmitter power consumption	Transmitting 17mA / stand by 16uA
Machine Safety Normative	13849-1:2015 PL-C Categ. 2, with TEST before every manoeuvre
Reaction time	<60 ms

CE DECLARATION OF CONFORMITY
For more information visit the website www.aerf.eu

WARNING!!

- Installation, start-up, modification and updating of the system may only be carried out by a qualified person.
- Switch off the operating voltage before working on the system.
- The system doesn't have fuse protection. It is recommended to include exterior protection from 100mA to 250mA.
- In case of any hypothetical issue, please do a memory reset (point 5.1).

